

ERHLED LED Outdoor

Polycarbonate / Die-Cast Remote Head

ILLUMINATION

- Long lasting, efficient, ultra bright white LED lamp heads.
- 1.0 watt (8 LEDs x 0.125 watt) per head.
- High performance chrome-plated metalized reflector and plastic lens for optimal light distribution.
- Adjustable performance chrome-plated metalized reflector and plastic lens for optimal light distribution.
- operational high lumen heads are 1.5 watts (12 LEDs x 0.125 watt per head) and provide increased center-to-center spacing.

ELECTRICAL

- Powered from low voltage power source with low voltage wiring (not provided).

MOUNTING

- Universal mounting adapter plate included. Mounts to single-gang switch box.
- Distance of maximum run is determined by system voltage, wire gauge and total maximum wattage on the run.
- Suitable for wall or ceiling mount.

HOUSING

- Available in both engineering grade, high-impact resistant polycarbonate or premium grade die-cast aluminum housing.
- Sealed and gasketed in standard gray or black finish.

WARRANTY / LISTING

- Five year warranty.
- UL Listed for wet locations (-30°C – 50°C).
- Meets UL924, NFPA 101 Life Safety Code, NEC, OSHA, Local and State Codes.

STANDARD



DIMENSIONS

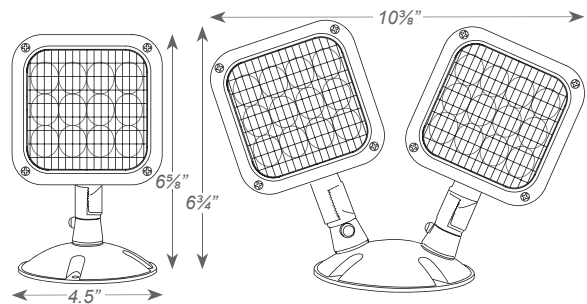

ORDERING INFORMATION

Sample Part Number: ERHLED

PART#	No. of HEADS	OPTIONS	HOUSING	VOLTAGE	COLOR	LAMP TYPE ¹
ERHLED	1 Single Head	(blank) For Standard Non-Self-Diagnostic Fixtures	PWP Thermoplastic	MV For Use With 3.6V, 6V, 9.6V & 12V DC Power Source	(blank) Gray	(blank) 8 LEDs 1W
	2 Double Head	SDT For Use With Fixtures With A Self-Diagnostic Option	WP Die-Cast		B Black	HL 12 LEDs 1.5W

¹ Wattage rating stated per head.

2025.06